

Bulkhead Union

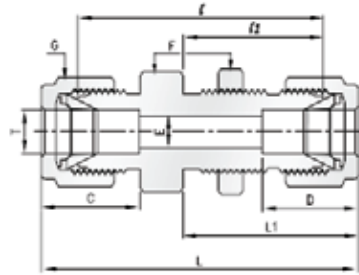

Dimensions:

Part No.	Tube O. D. T in	E Min	Width across flat		D	C	l	l ₁	L	L ₁	Panel Hole Drill Size	Panel Max. Thickness
			F Min	G in								
S1-200BLN-01	1/16	1.27	5/16	5/16	8.63	10.92	23.88	13.46	31.50	17.27	5.16	3.05
S1-200BLN-02	1/8	2.28	1/2	7/16	12.70	15.24	38.10	24.63	51.30	31.24	8.33	12.70
S1-200BLN-03	3/16	3.04	9/16	1/2	13.71	16.00	40.37	25.40	53.59	32.00	9.92	12.70
S1-200BLN-04	1/4	4.82	5/8	9/16	15.24	17.78	42.93	26.16	57.65	35.52	11.50	10.16
S1-200BLN-05	5/16	6.35	11/16	5/8	16.25	18.54	45.98	28.44	60.70	35.81	13.09	11.17
S1-200BLN-06	3/8	7.11	3/4	11/16	16.76	19.30	47.51	29.46	62.23	36.83	14.65	11.17
S1-200BLN-08	1/2	10.41	15/16	7/8	22.86	21.84	50.80	31.75	71.12	41.91	19.44	12.70
S1-200BLN-10	5/8	12.70	1-1/16	1	24.38	21.84	52.32	32.51	72.64	42.67	22.62	12.70
S1-200BLN-12	3/4	15.74	1-3/16	1-1/8	24.38	21.84	58.67	37.33	78.99	47.49	25.79	16.76
S1-200BLN-14	7/8	18.28	1-3/8	1-1/4	25.90	21.84	64.26	42.92	84.58	53.08	28.97	19.05
S1-200BLN-16	1	22.35	1-5/8	1-1/2	31.24	26.41	71.37	45.21	95.75	57.40	33.73	19.05