

OIL COUNTRY FITTINGS



Swage Nipple
Standard / XH



Bull Plug
Standard / XH / TAP



Specification:

- Oil Country Size Swage Nipple and Bull Plugs are manufactured in conformance with API 5CT and MSS-SP95.
- The material for Swage Nipples and Bull Plugs conform to the requirements of J55 materials.
- 8R, 8V & LP threads on Swage Nipples and Bull Plugs conform to ANSI/ASME B1.20.1, API 5B.
- The electro-galvanized coating on the Swage Nipples and Bull plugs conform to ASTM B633-86 Type III Class III.
- Based on working pressure formulas from which the end user may choose to determine the required schedule of the piping system.
- The chemical and physical properties of the raw material fall within the ranges listed below. Please contact UVI for exact Dimensional/Material information.

MARKING SYMBOL	J55 - PHYSICAL REQUIREMENTS	
	TENSILE	YIELD
COP	≥ 517 MPa	379 - 552 MPa

J55 - CHEMICAL COMPOSITION REQUIREMENTS								
C	MN	P	S	SI	CR	AI	NI	CU
0.34 to 0.39	1.25 to 1.50	≤ 0.020	≤ 0.015	0.20 to 0.35	≤ 0.15	≤ 0.020	≤ 0.20	≤ 0.20

ENGINEER APPROVAL

JOB: _____ DATE: ___/___/___

MEETS DIMENSIONAL SPECIFICATIONS: YES NO

MEETS MATERIAL SPECIFICATIONS: YES NO

MEETS PRESSURE / TEMPERATURE SPECIFICATIONS: YES NO

NOTES: _____

ENGINEER NAME: _____

ENGINEER SIGNATURE: _____

* Due to the continuous development of our products, design or construction may change without prior notice.

OIL COUNTRY FITTINGS

API - Bull Plugs

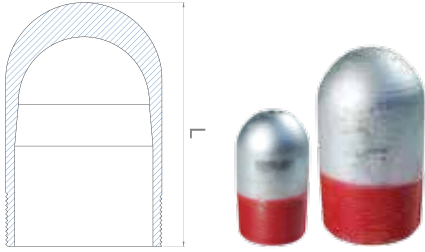

Weights (LBS) • Dimensions (IN)

2"	ITEM CODE	SIZE	L	WEIGHT
	OCBP2STD	2 UP 8 R STD	5	3.05
	OCBP2STD.5T	2 UP 8 R STD TAP1/2 LP	5	3.05
	OCBP2XH	2 UP 8 R XH	5	3.40
	OCBP2XH.5T	2 UP 8 R XH TAP1/2 LP	5	3.40

Weights (LBS) • Dimensions (IN)

2½"	ITEM CODE	SIZE	L	WEIGHT
	OCBP2.5STD	2-1/2 UP 8 R STD	5½	4.60
	OCBP2.5STD.5T	2-1/2 UP 8 R STD TAP1/2 LP	5½	4.35
	OCBP2.5XH	2-1/2 UP 8 R XH	5½	5.05
	OCBP2.5XH.5T	2-1/2 UP 8 R XH TAP1/2 LP	5½	5.05

Weights (LBS) • Dimensions (IN)

3"	ITEM CODE	SIZE	L	WEIGHT
	OCBP3STD	3 UP 8 R STD	6½	7.30
	OCBP3STD.5T	3 UP 8 R STD TAP1/2 LP	6½	6.95
	OCBP3XH	3 UP 8 R XH	6½	7.95
	OCBP3XH.5T	3 UP 8 R XH TAP1/2 LP	6½	11.85

API - Swage Nipples

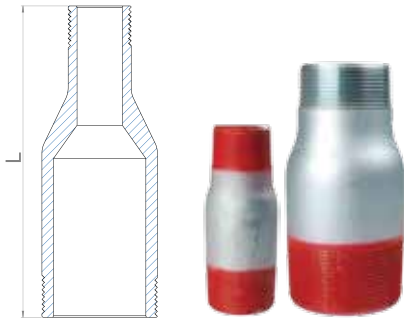

Weights (LBS) • Dimensions (IN)

2½"	ITEM CODE	SIZE	L	WEIGHT
	OCSN2.5UX2USTD	2-1/2 UP 8 R X 2 UP 8 R STD	8	5.65
	OCSN2.5UX2UXH	2-1/2 UP 8 R X 2 UP 8 R XH	8	6.50
	OCSN2.5UX2LSTD	2-1/2 UP 8 R x 2 LP STD	8	5.10
	OCSN2.5UX2LXH	2-1/2 UP 8 R x 2 LP XH	8	5.85

Weights (LBS) • Dimensions (IN)

3"	ITEM CODE	SIZE	L	WEIGHT
	OCSN3UX2.5USTD	3 UP 8 R X 2-1/2 UP 8 R STD	8	7.35
	OCSN3UX2.5UXH	3 UP 8 R X 2-1/2 UP 8 R XH	8	8.80
	OCSN3UX2.5VSTD	3 UP 8 R x 2-1/2 8 V STD	8	6.60
	OCSN3UX2.5VXH	3 UP 8 R x 2-1/2 8 V XH	8	7.75
	OCSN3VX2USTD	3 8 V x 2 UP 8 R STD	8	5.40
	OCSN3VX2UXH	3 8 V x 2 UP 8 R XH	8	6.55
	OCSN3VX2.5USTD	3 8 V x 2-1/2 UP 8 R STD	8	5.65
	OCSN3VX2.5UXH	3 8 V x 2-1/2 UP 8 R XH	8	7.05

OIL COUNTRY FITTINGS

API - Tubing Nipples

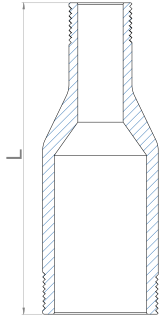

Weights (LBS) • Dimensions (IN)

2"	ITEM CODE	SIZE	L	WEIGHT
	OCSN2UX2LSTD	2 UP 8 R x 2 LP STD	8	2.95
	OCSN2UX2LXH	2 UP 8 R x 2 LP XH	8	3.45

Weights (LBS) • Dimensions (IN)

3"	ITEM CODE	SIZE	L	WEIGHT
	OCSN3UX3VSTD	3 UP 8 R x 3 8 V STD	8	7.10
	OCSN3UX3VXH	3 UP 8 R x 3 8 V XH	8	8.30

API - Casing Nipples

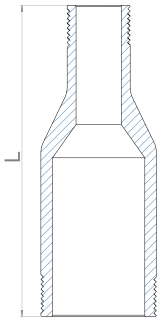

Weights (LBS) • Dimensions (IN)

4 1/2"	ITEM CODE	SIZE	L	WEIGHT
	OCSN4.5ODX2LSTD	4-1/2 OD 8 R x 2 LP STD	9	6.05
	OCSN4.5ODX2LXH	4-1/2 OD 8 R x 2 LP XH	9	7.80
	OCSN4.5ODX3VSTD	4-1/2 OD 8 R x 3 8 V STD	9	7.25
	OCSN4.5ODX3VXH	4-1/2 OD 8 R x 3 8 V XH	9	9.95

Weights (LBS) • Dimensions (IN)

5 1/2"	ITEM CODE	SIZE	L	WEIGHT
	OCSN5.5ODX3VSTD	5-1/2 OD 8 R x 3 8 V STD	11	13.30
	OCSN5.5ODX3VXH	5-1/2 OD 8 R x 3 8 V XH	11	15.00
	OCSN5.5ODX2LSTD	5-1/2 OD 8 R x 2 LP STD	11	12.30
	OCSN5.5ODX2LXH	5-1/2 OD 8 R x 2 LP XH	11	14.05
	OCSN5.5ODX4.5ODSTD	5-1/2 OD 8 R x 4-1/2 OD 8 R STD	11	12.30
	OCSN5.5ODX4.5ODXH	5-1/2 OD 8 R x 4-1/2 OD 8 R XH	11	16.25