

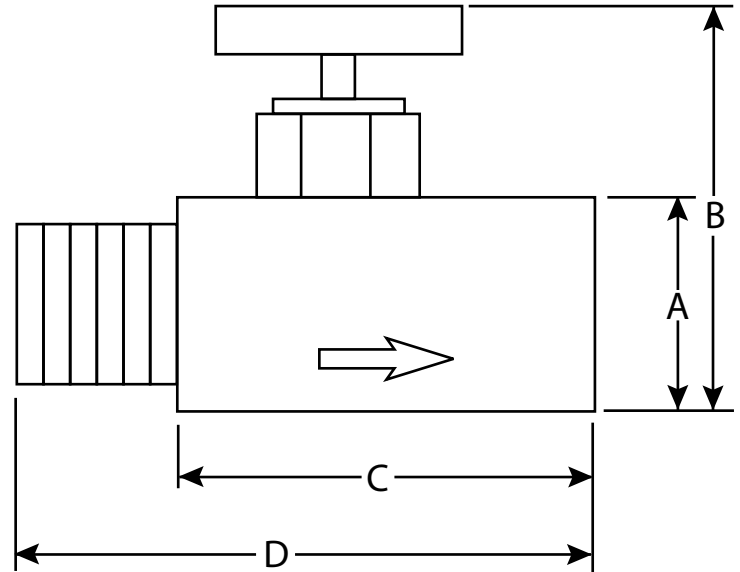

CARBON STEEL MINI NEEDLE VALVE

SERIES: MVDC



SPECIFICATIONS

RATED TO 6,000 PSI
CARBON STEEL CONSTRUCTION
VITON PACKING AND SEALS
WORKING TEMPERATURE -20 DEG F TO 100 DEG F
THREADS CONFORM TO ASME B1.20.1
AVAILABLE IN MxM, MxF AND FXF

PART	MATERIAL
ROUND KNOB	CARBON STEEL
STEM	304 STAINLESS STEEL
BONNET	CARBON STEEL
VALVE BODY	CARBON STEEL

DIMENSIONS

NPS	PART #	STYLE	WEIGHT	A	B	C	D
1/4"	COPMVDC4	FXF	0.66	.75"	1.718"	1.312"	1.812"
1/4"	COPMVDC5	MXM	0.66	.75"	1.718"	1.312"	1.812"
1/4"	COPMVDC6	MXF	0.66	.75"	1.718"	1.312"	1.812"

* Due to the continuous development of our products, design or construction may change without prior notice